

FLANGE CHOICE

For the choice of flanges a great variety of combinations concerning connection dimensions, materials and coatings is available.

Also two different flange types on one compensator are possible.

On the following pages the most common types and dimensions are listed.

Special types are available upon request.

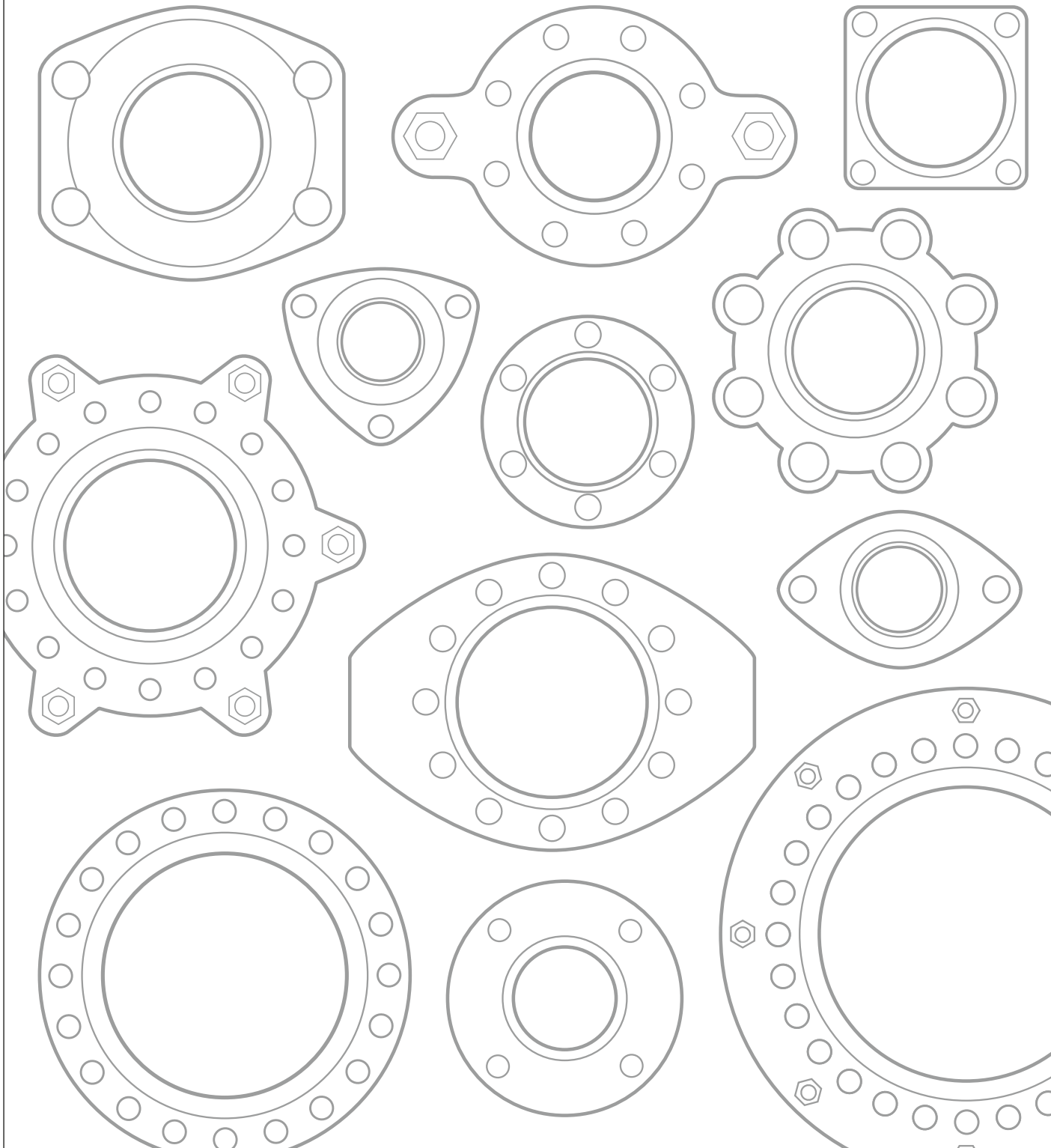

• Commonly used Flange Measurements

Flange Standard		EN 1092-1																							
		DIN PN 6				DIN PN 10				DIN PN 16				DIN PN 25				DIN PN 40							
Part Number		.6				.10				.16				.25				.40							
DN		D	k	n	l	D	k	n	l	D	k	n	l	D	k	n	l	D	k	n	l				
mm	in.	mm	mm		mm	mm	mm		mm	mm	mm		mm	mm	mm		mm	mm	mm		mm				
25	1"					identical with PN 16								115	85	4	14	115	85	4	14	identical with PN 25			
32	1 ¼"	120	90	4	14									140	100	4	18	140	100	4	18				
40	1 ½"	130	100	4	14									150	110	4	18	150	110	4	18				
50	2"	140	110	4	14									165	125	4	18	165	125	4	18				
65	2 ½"	160	130	4	14									185	145	4 ¹⁾	18	185	145	8	18				
80	3"	190	150	4	18									200	160	8	18	200	160	8	18				
100	4"	210	170	4	18									220	180	8	18	235	190	8	22				
125	5"	240	200	8	18									250	210	8	18	270	220	8	26				
150	6"	265	225	8	18									285	240	8	22	300	250	8	26				
200	8"	320	280	8	18	340	295	8	22	340	295	12	22	360	310	12	26	375	320	12	30				
250	10"	375	335	12	18	395	350	12	22	405	355	12	26	425	370	12	30	450	385	12	33				
300	12"	440	395	12	22	445	400	12	22	460	410	12	26	485	430	16	30	515	450	16	33				
350	14"	490	445	12	22	505	460	16	22	520	470	16	26	555	490	16	33	580	510	16	36				
400	16"	540	495	16	22	565	515	16	26	580	525	16	30	620	550	16	36	660	585	16	39				
450	18"	595	550	16	22	615	565	20	26	640	585	20	30	670	600	20	36	685	610	20	39				
500	20"	645	600	20	22	670	620	20	26	715	650	20	33	730	660	20	36	755	670	20	42				
600	24"	755	705	20	26	780	725	20	30	840	770	20	36	845	770	20	39								
700	28"	860	810	24	26	895	840	24	30	910	840	24	36	960	875	24	42								
800	32"	975	920	24	30	1015	950	24	33	1025	950	24	39	1085	990	24	48								
900	36"	1075	1020	24	30	1115	1050	28	33	1125	1050	28	39	1185	1090	28	48								
1000	40"	1175	1120	28	30	1230	1160	28	36	1255	1170	28	42	1320	1210	28	56								

Materials: zinc plated steel (standard), stainless steel, bronze, aluminium, hot galvanized steel, Rilsan® coated steel etc. – see page 403

¹⁾ differing from EN 1092-1

Flange Standard		EN 1759-1 ANSI B 16.5 150 lb/sq. in						EN 1759-1 ANSI B 16.5 300 lb/sq. in.						SAE J518 c max. Betriebsdruck/W.P. 10 bar							
		.ASA 150						.ASA 300						.SAE							
DN		D		k		n	l		D		k		n	l		G	H	I	L	n	l
mm	in.	mm	in.	mm	in.		mm	in.	mm	in.	mm	in.		mm	in.	mm	mm	mm	mm	mm	mm
25	1"	108,0	4 ½"	79,4	3 ½"	4	15,9	¾"	123,8	4 7/8"	88,9	3 ½"	4	19,0	¾"						
32	1 ¼"	117,5	4 5/8"	88,9	3 ½"	4	15,9	¾"	133,4	5 ¼"	98,4	3 7/8"	4	19,0	¾"	79	58,7	30,2	73	4	13
40	1 ½"	127,0	5"	98,4	3 7/8"	4	15,9	¾"	155,6	6 1/8"	114,3	4 3/4"	4	22,2	¾"	94	70,0	35,7	83	4	13
50	2"	152,4	6"	120,7	4 ¾"	4	19,0	¾"	165,1	6 ½"	127,0	5"	8	19,0	¾"	102	78,0	42,9	97	4	13
65	2 ½"	177,8	7"	139,7	5 ½"	4	19,0	¾"	190,5	7 ½"	149,2	5 7/8"	8	22,2	7/8"	114	89,0	50,8	115	4	13
80	3"	190,5	7 ½"	152,4	6"	4	19,0	¾"	209,6	8 ¼"	168,3	6 5/8"	8	22,2	7/8"	135	106,4	61,9	131	4	17
100	4"	228,6	9"	190,5	7 ½"	8	19,0	¾"	254,0	10"	200,0	7 7/8"	8	22,2	7/8"	162	130,2	77,8	152	4	17
125	5"	254,0	10"	215,9	8 ½"	8	22,2	7/8"	279,4	11"	235,0	9 ¼"	8	22,2	7/8"	184	152,4	92,1	181	4	17
150	6"	279,4	11"	241,3	9 ½"	8	22,2	7/8"	317,5	12 ½"	269,9	10 5/8"	12	22,2	7/8"						
200	8"	342,9	13 ½"	298,5	11 ¾"	8	22,2	7/8"	381,0	15"	330,2	13"	12	25,4	1"						
250	10"	406,4	16"	361,9	14 ¼"	12	25,4	1"	444,5	17 ½"	387,3	15 ¼"	16	28,6	1 1/8"						
300	12"	482,6	19"	431,8	17"	12	25,4	1"	520,7	20 ½"	450,8	17 ¾"	16	31,7	1 ¼"						
350	14"	533,4	21"	476,2	18 ¾"	12	28,6	1 1/8"	584,2	23"	514,3	20 ¼"	20	31,7	1 ¼"						
400	16"	596,9	23 ½"	539,7	21 ¼"	16	28,6	1 1/8"	647,7	25 ½"	571,5	22 ½"	20	34,9	1 3/8"						
450	18"	635,0	25"	577,9	22 ¾"	16	31,7	1 ¼"	711,2	28"	628,7	24 ¾"	24	34,9	1 3/8"						
500	20"	698,5	27 ½"	635,0	25"	20	31,7	1 ¼"	774,7	30 ½"	685,8	27"	24	34,9	1 3/8"						
600	24"	812,8	32"	749,3	29 ½"	20	34,9	1 3/8"	914,4	36"	812,8	32"	24	41,3	1 5/8"						

Materials: zinc plated steel (standard), stainless steel, bronze, aluminium, hot galvanized steel, Rilsan® coated steel etc. – see page 403

Flange Standard		BS 10 table D								BS 10 table E								BS 10 table F							
Part Number		.BS 10D								.BS 10E								.BS 10F							
DN		D		k		n	l		D		k		n	l		D		k		n	l				
mm	in.	mm	in.	mm	in.		mm	in.	mm	in.	mm	in.		mm	in.	mm	in.	mm	in.		mm	in.			
25	1"	114,3	4 1/2"	82,5	3 1/4"	4	14,3	9/16"	114,3	4 1/2"	82,5	3 1/4"	4	14,3	9/16"	120,6	4 3/4"	87,3	3 7/16"	4	17,5	11/16"			
32	1 1/4"	120,6	4 3/4"	87,3	3 7/16"	4	14,3	9/16"	120,6	4 3/4"	87,3	3 7/16"	4	14,3	9/16"	133,3	5 1/4"	98,4	3 7/8"	4	17,5	11/16"			
40	1 1/2"	133,3	5 1/4"	98,4	3 7/8"	4	14,3	9/16"	133,3	5 1/4"	98,4	3 7/8"	4	14,3	9/16"	139,7	5 1/2"	104,8	4 1/8"	4	17,5	11/16"			
50	2"	152,4	6"	114,3	4 1/2"	4	17,5	11/16"	152,4	6"	114,3	4 1/2"	4	17,5	11/16"	165,1	6 1/2"	127,0	5"	4	17,5	11/16"			
65	2 1/2"	165,1	6 1/2"	127,0	5"	4	17,5	11/16"	165,1	6 1/2"	127,0	5"	4	17,5	11/16"	184,1	7 1/4"	146,0	5 3/4"	8	17,5	11/16"			
80	3"	184,1	7 1/4"	146,0	5 3/4"	4	17,5	11/16"	184,1	7 1/4"	146,0	5 3/4"	4	17,5	11/16"	203,2	8"	165,1	6 1/2"	8	17,5	11/16"			
100	4"	215,9	8 1/2"	177,8	7"	4	17,5	11/16"	215,9	8 1/2"	177,8	7"	8	17,5	11/16"	228,6	9"	190,5	7 1/2"	8	17,5	11/16"			
125	5"	254,0	10"	209,5	8 1/4"	8	17,5	11/16"	254,0	10"	209,5	8 1/4"	8	17,5	11/16"	279,4	11"	234,9	9 1/4"	8	22,2	7/8"			
150	6"	279,4	11"	234,9	9 1/4"	8	17,5	11/16"	279,4	11"	234,9	9 1/4"	8	22,2	7/8"	304,8	12"	260,3	10 1/4"	12	22,2	7/8"			
200	8"	336,5	13 1/4"	292,1	11 1/2"	8	17,5	11/16"	336,5	13 1/4"	292,1	11 1/2"	8	22,2	7/8"	368,3	14 1/2"	323,9	12 3/4"	12	22,2	7/8"			
250	10"	406,4	16"	355,6	14"	8	22,2	7/8"	406,4	16"	355,6	14"	12	22,2	7/8"	431,8	17"	381,0	15"	12	25,4	1"			
300	12"	457,2	18"	406,4	16"	12	22,2	7/8"	457,2	18"	406,4	16"	12	25,4	1"	489,0	19 1/4"	438,1	17 1/4"	16	25,4	1"			

Materials: zinc plated steel (standard), stainless steel, bronze, aluminium, hot galvanized steel, Rilsan® coated steel etc. – see page 403

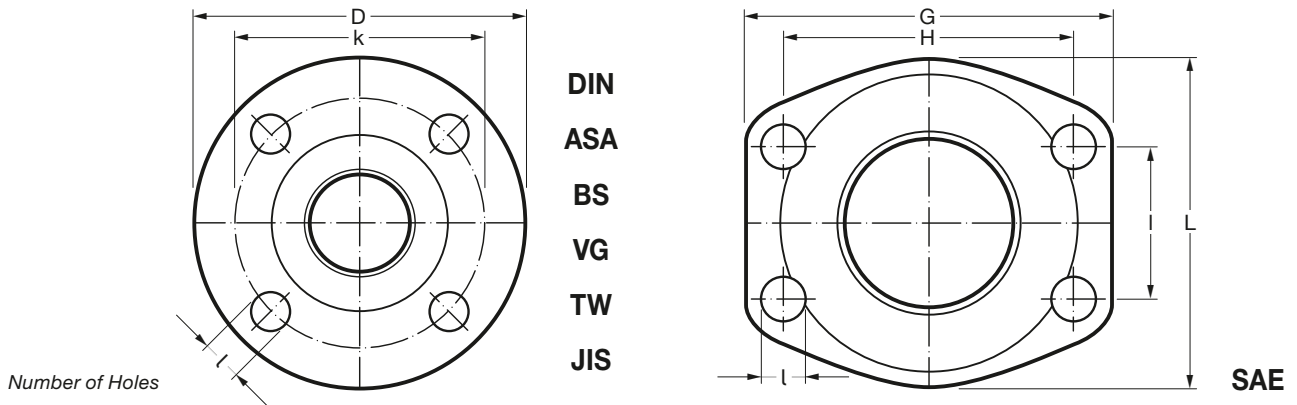

Flange Standard		VG 95959-1				DIN 28460 'TW' /W.P. 10bar				JIS 5K				JIS 10K				JIS 16K			
Part Number		.VG-1				.TW				.JIS 5K				.JIS 10K				.JIS 16K			
DN		D	k	n	l	D	k	n	l	D	k	n	l	D	k	n	l	D	k	n	l
mm	in.	mm	mm		mm	mm	mm		mm	mm	mm		mm	mm	mm	mm	mm	mm	mm		mm
25	1"													125	90	4	19	125	90	4	19
32	1 1/4"	100	76	6	11					115	90	4	15	135	100	4	19	135	100	4	19
40	1 1/2"	108	84	6	11					120	95	4	15	140	105	4	19	140	105	4	19
50	2"	120	96	6	11	154	130	8	11,5	130	105	4	15	155	120	4	19	155	120	8	19
65	2 1/2"	140	116	8	11	154	130	8	11,5	155	130	4	15	175	140	4	19	175	140	8	19
80	3"	150	126	8	11	154	130	8	11,5	180	145	4	19	185	150	8	19	200	160	8	23
100	4"	172	148	10	11	174	150	8	14,0	200	165	8	19	210	175	8	19	225	185	8	23
125	5"	200	176	10	11	204	176	8	14,0	235	200	8	19	250	210	8	23	270	225	8	25
150	6"	226	202	12	11	240	210	12	14,0	265	230	8	19	280	240	8	23	305	260	12	25
200	8"	288	264	16	11	308	274	16	16,0	320	280	8	23	330	290	12	23	350	305	12	25
250	10"									385	345	12	23	400	355	12	25	430	380	12	27
300	12"									430	390	12	23	445	400	16	25	480	430	16	27
350	14"									480	435	12	25	490	445	16	25	540	480	16	33
400	16"									540	495	16	25	560	510	16	27	605	540	16	33
450	18"									605	555	16	25	620	565	20	27	675	605	20	27
500	20"									655	605	20	25	675	620	20	27	730	660	20	33
600	24"									770	715	20	27	795	730	24	33	845	770	24	39

Materials: zinc plated steel (standard), stainless steel, bronze, aluminium, hot galvanized steel, Rilsan® coated steel etc. (by 'TW' up to DN 150 aluminium = standard) – see page 403

• ERV Tie Rods and Angular Limiters

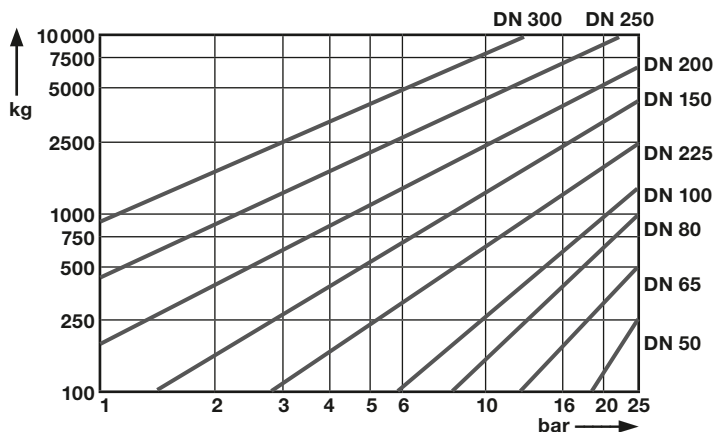

Pressure thrust forces of ERV Expansion Joints (installation length = 130 mm)

DN mm	Number tie rods	Part Number Type
25	2	ERV 25 ... ZS
32	2	ERV 32 ... ZS
40	2	ERV 40 ... ZS
50	2	ERV 50 ... ZS
65	2	ERV 65 ... ZS
80	2	ERV 80 ... ZS
100	2	ERV 100 ... ZS
125	2	ERV 125 ... ZS
150	2	ERV 150 ... ZS
200	2	ERV 200 ... ZS
250	2	ERV 250 ... ZS
300	4	ERV 300 ... ZS
350	4	ERV 350 ... ZS
400	4	ERV 400 ... ZS
450	4	ERV 450 ... ZS
500	4	ERV 500 ... ZS
600	4	ERV 600 ... ZS

Values for flanges DIN PN 10, number of tie rods may change with different flange standards.

Tied Flanges – Type ZS

The table shows that the pressure thrust forces in small ERV dimensions up to DN 50 are this low that limiters normally are not necessary. Limiters are recommended when it is not possible to secure the pipe system with sufficient fixed points or when a part relief of the fixed points is desired.

The required limiters are measured to absorb also the reaction forces resulting from the test pressure.

For the mainly required axial limitation the shown types with integrated tie bars have proved well. The tie bars with high stability (steel 8.8) can be adjusted to the actual installation measurements. The tie bars lie elastically in noise reducing rubber bushes of weatherproof rubber. From DN 350 the tie rods lie in principal in conical seats and spherical washers.

When assembling ERV ZS / ZSS ensure that the nuts on the threaded rods are fixed with locking nuts. Please observe the Maximum admissible (L max) elongation of the bellows stated on our catalogue.

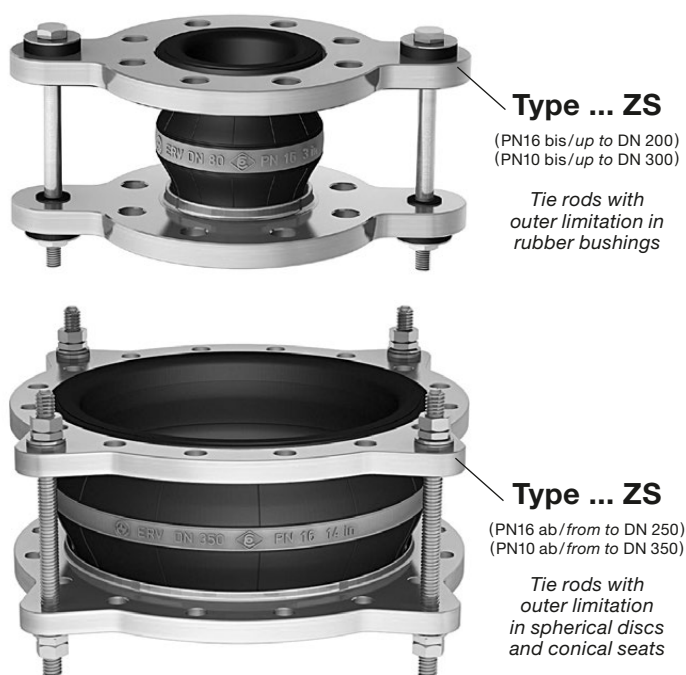

• Special Designs

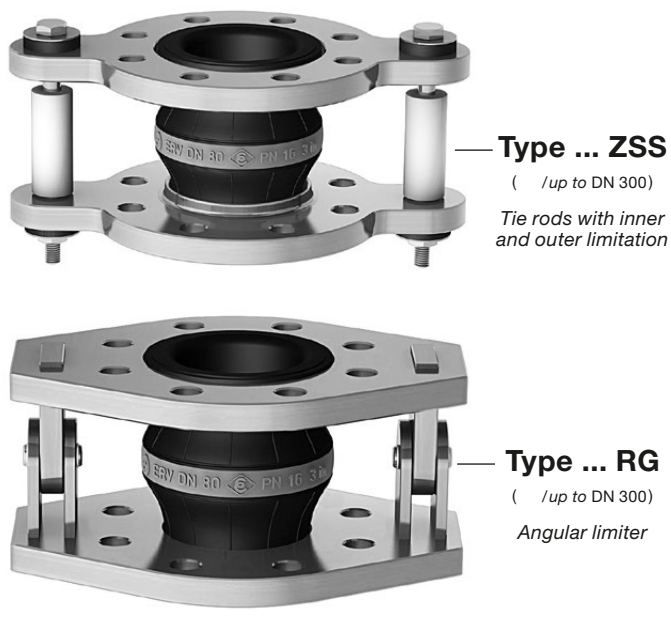

Type for ERV with flanges according to DIN PN 10 / 16

25	30	170	260	FSH für/for ERV 25x130
32	40	190		FSH für/for ERV 32x130
40	45	195		FSH für/for ERV 40x130
50	60	210		FSH für/for ERV 50x130
65	75	225		FSH für/for ERV 65x130
80	90	240		FSH für/for ERV 80x130
100	110	260		FSH für/for ERV 100x130
125	135	285		FSH für/for ERV 125x130
150	160	330		FSH für/for ERV 150x130
200	220	385		FSH für/for ERV 200x130
250	265	435		FSH für/for ERV 250x130
300	315	485		FSH für/for ERV 300x130
25	30	170		300
32	40	190	FSH für/for ERV 32x160	
40	45	195	FSH für/for ERV 40x160	
50	60	210	FSH für/for ERV 50x160	
65	75	225	FSH für/for ERV 65x160	
80	90	240	FSH für/for ERV 80x160	
100	110	260	FSH für/for ERV 100x160	
125	135	285	FSH für/for ERV 125x160	
150	160	330	FSH für/for ERV 150x160	
200	220	385	FSH für/for ERV 200x160	
250	265	435	340	FSH für/for ERV 250x200
300	315	485		FSH für/for ERV 300x200

Type for ERV with flanges according to VG 95959-1 (German Naval Standard)

32	40	150	260	FSH-M für/for ERV 32x130
40	45	155		FSH-M für/for ERV 40x130
50	60	170		FSH-M für/for ERV 50x130
65	75	185		FSH-M für/for ERV 65x130
80	90	200		FSH-M für/for ERV 80x130
100	110	220		FSH-M für/for ERV 100x130
125	135	245		FSH-M für/for ERV 125x130
150	160	270		FSH-M für/for ERV 150x130
200	215	345		FSH-M für/for ERV 200x130
250	265	395		FSH-M für/for ERV 250x13
32	40	150	300	FSH-M für/for ERV 32x160
40	45	155		FSH-M für/for ERV 40x160
50	60	170		FSH-M für/for ERV 50x160
65	75	185		FSH-M für/for ERV 65x160
80	90	200		FSH-M für/for ERV 80x160
100	110	220		FSH-M für/for ERV 100x160
125	135	245		FSH-M für/for ERV 125x160
150	160	270		FSH-M für/for ERV 150x160
200	215	345		FSH-M für/for ERV 200x160
250	265	395		340

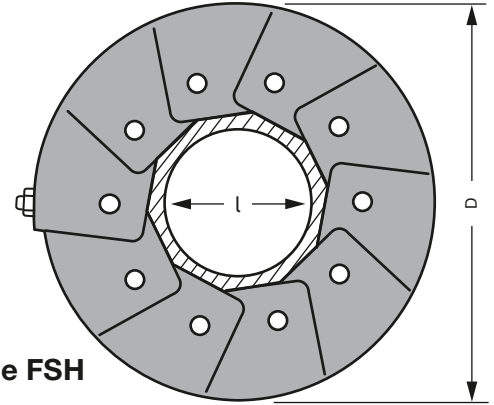

Type FSH

Flame protection cover for ERV rubber expansion joints, made of several layers of glass fiber fabric with a surface cover of silver-coloured high temperature resistant silicone-aluminium-glas fabric (certified acc. MED A1/3.13). Screws, nuts and washers of brass. It reliably protects the expansion joint against radiation heat and direct flames up to 800°C for 30 min. (ISO 15540). Flame protection covers are resistant against oil and chemical influences as well as against ageing and weathering.

Due to its split design the flame protection cover can be mounted subsequently and re-opened. Dimensions are chosen in a way that also the counter flanges are completely covered. The allowed range of movement is not restricted.

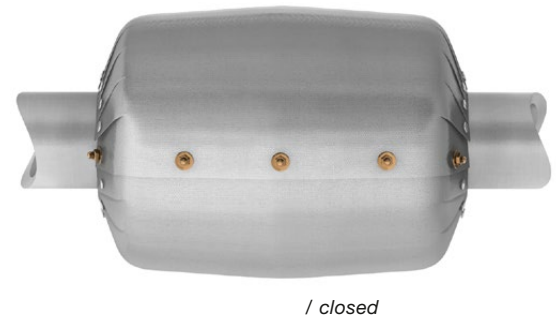
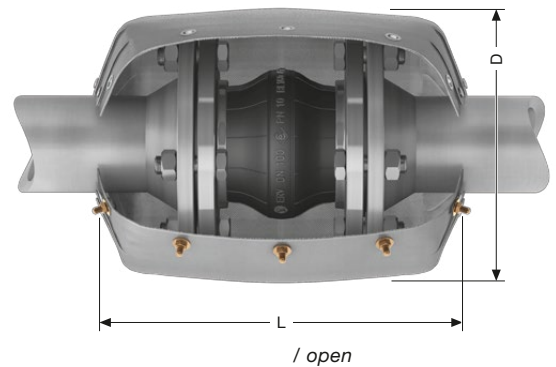

- Specifications subject to change without notice - Copyright ELAFLEX HIBY