

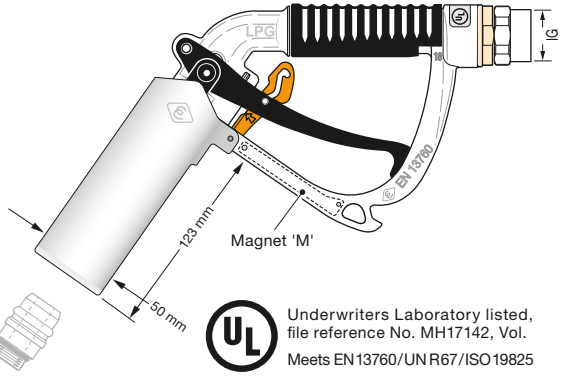
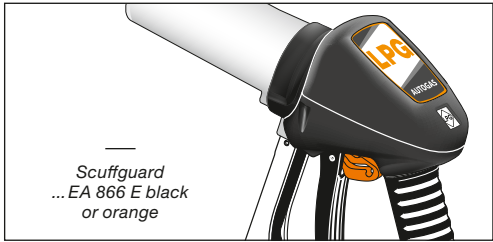

Specifications subject to change without notice · Copyright ELAFLEX HIBY

<p>5 Section</p>	<p>Construction Details · Materials · Weight Application Specification</p>	<p>Hose Inlet Thread Type + Size G</p>	<p>Part Number Type</p>	
	<p>LPG nozzle to ISO 19825 for vehicle refuelling with liquefied petroleum gas (propane, butane and mixtures) up to 50 l/min. Working pressure 25 bar. Test pressure 40 bar. Burst pressure > 100 bar. Temperature range -40° up to +70° C.</p> <p>Safety features: The nozzle only allows gas to flow when it is correctly coupled. No opening possible when coupled misaligned. The discharge volume of gas when uncoupling is minimal, direction of discharge turned away from the user. Lever Hold-Open Latch mechanism.</p> <p>Construction EURO (Push-In-Coupling): Nozzle body aluminium, comfigrip PVC, easy rotating swivel EA 820 LT stainless steel/brass, coupling nut stainless steel, inner parts stainless steel/acetal resin/PA, lever and latch PA. Seals NBR-LT and PU-LT.</p> <p>One-handed operation possible.</p> <p>Note: ZVG 2 EURO UL come with hold-open latch as standard. ZVG 2 EURO UL latched nozzles are covered by UL 125 and UL 567.</p> <p>Gas release volume: < 1 cm³.</p> <p>ZVG 2 EURO UL weight: ≈ 1,41 kg</p>	<p>3/4" NPT IG 3/4" NPT female</p>	<p>ZVG2 EURO UL.3</p>	<p>ZVG 2 EURO UL</p>  
<p>· Additional Type Numbers</p>				
	<p>With Magnet incorporated in the nozzle guard</p>	<p>... M</p>	<p>For contactless activation of the pump by Reed contacts</p>	
	<p>With Scuffguard black</p>	<p>... EA 866 E schwarz ... EA 866 E black</p>		
	<p>With Scuffguard orange</p>	<p>... EA 866 E orange ... EA 866 E orange</p>	<p>With fuel grade identification to EN 16942 and a large printing/advertising space. Materials: PU / PA, weather and deformation resistant. Further details see Information 4.17.</p>	
<p>2016 Revision 11.2022</p>			<p>LPG nozzles ZVG 2 Euro UL 573</p>	

Pressure Drop Chart

for GasGuard LPG nozzles

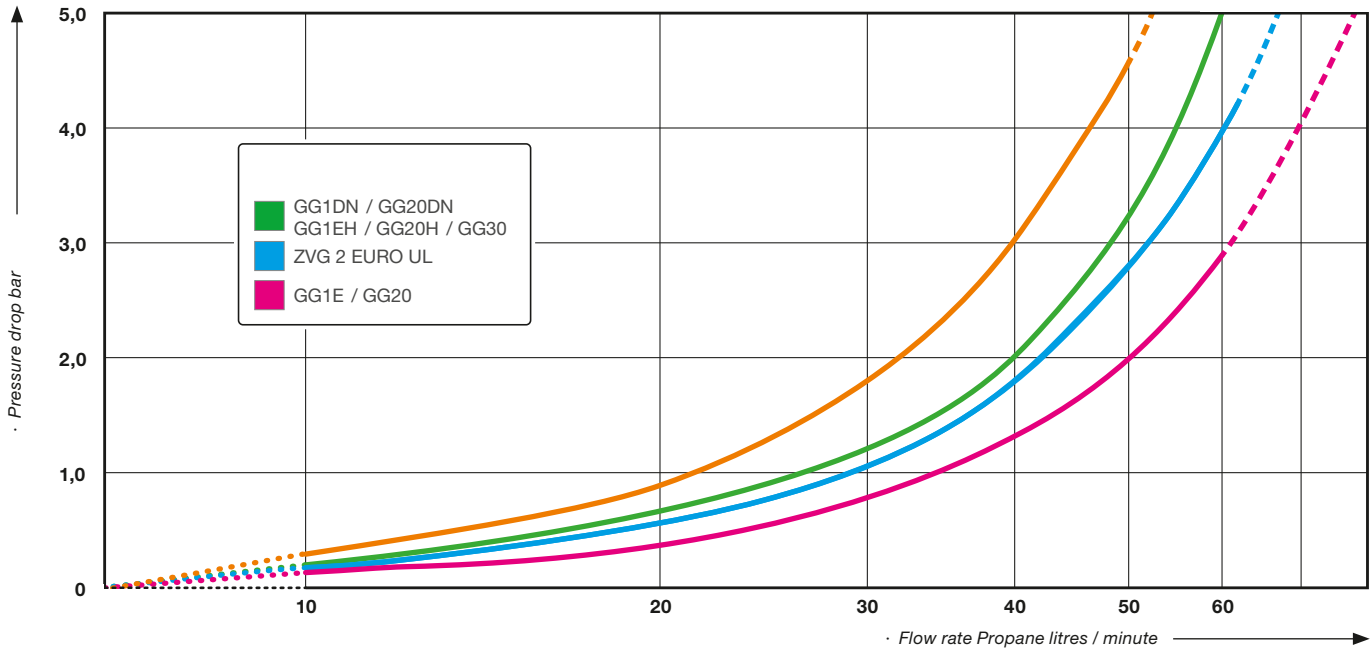

These values were obtained through regulated government laboratory testing at the National Measurement Institute in Sydney, Australia.

Common adapters without check valve were used. There is a wide variety of connections/adapters for vehicles used in market. This can lead to different values.

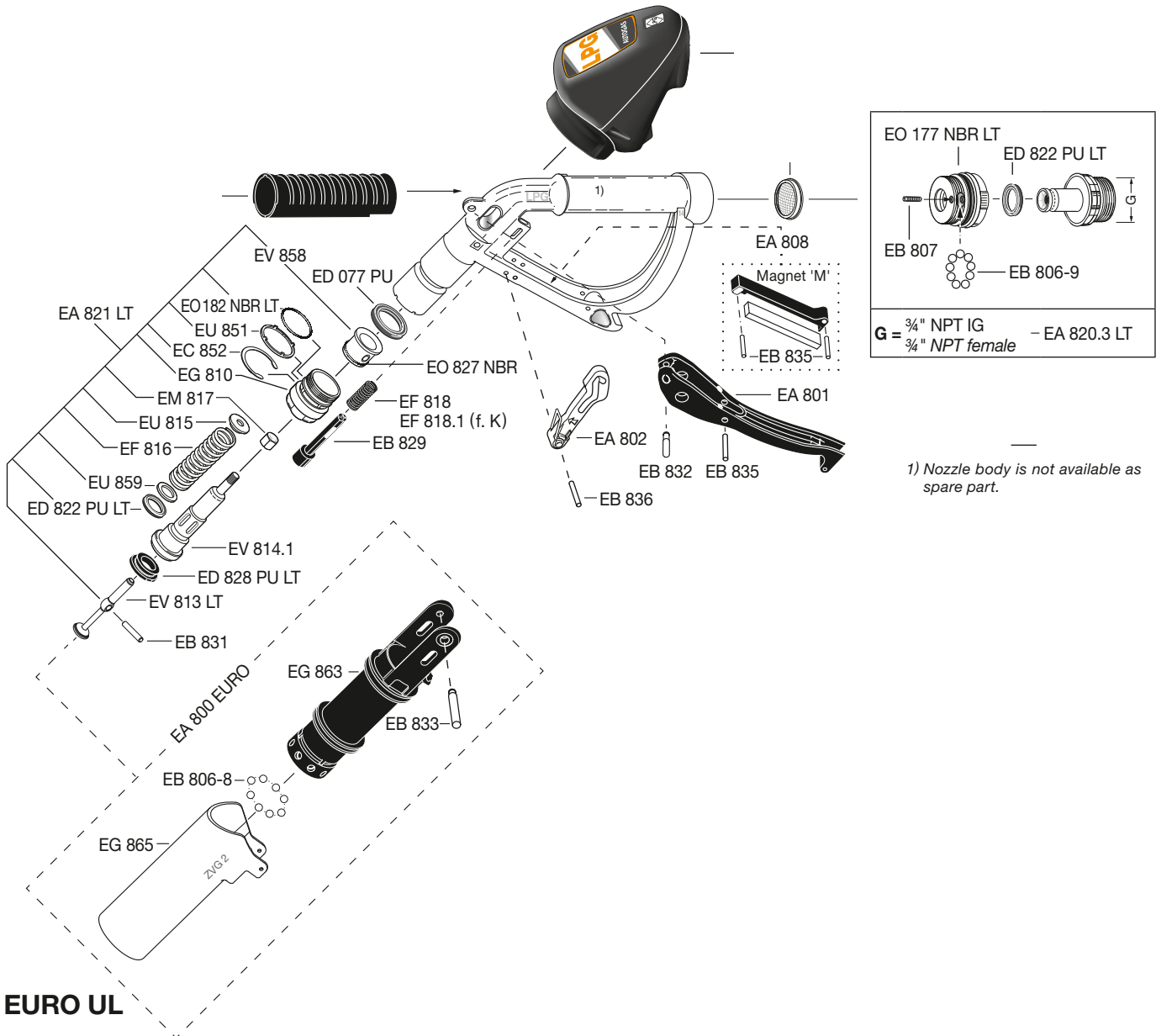

1) Nozzle body is not available as spare part.